

Type Designation	4914
Designation IEC	LR14
System	Zn-MnO ₂ (Alkaline)
Shelf Life (Coding)*	5 years
Nominal Voltage [V]	1.5
Typical Capacity C [mAh]	7800 (discharge with high-resistance)
Permissible Temperature Range	- 10 °C ... 50 °C
Weight, approx. [g]	69
Volume [ccm]	26.5

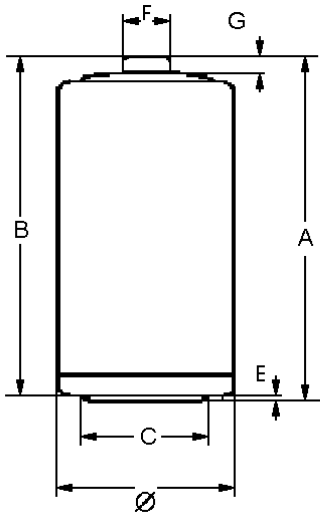

Dimensions [mm]	min:	max:
∅	24.9	26.2
A	-	50.0
B	48.6	-
C	13.0	-
E	-	0.9
F	-	7.5
G	1.5	-



Typical Capacities (at 20°C)

Discharge Type	Load	End Voltage[V]	1.0	0.9
4M/H,8H/D,7D/W	3.9 Ω	Time [m]	1170	1300
Portable Lighting		Capacity [Ah]	6.10	6.65
		Energy [Wh]	7.35	8.05
Discharge Type	Load	End Voltage[V]	0.9	0.8
1H/D,7D/W	3.9 Ω	Time [h]	20.60	23.10
Toys		Capacity [Ah]	6.01	6.58
		Energy [Wh]	7.01	7.45
Discharge Type	Load	End Voltage[V]	1.0	0.9
1H/D,7D/W	6.8 Ω	Time [h]	34.85	39.20
Tape Recorders		Capacity [Ah]	6.24	6.85
		Energy [Wh]	7.65	8.25
Discharge Type	Load	End Voltage[V]	1.0	0.9
4H/D,7D/W	20 Ω	Time [h]	114.00	131.00
Transistor Radios		Capacity [Ah]	7.10	8.00
		Energy [Wh]	9.15	9.90

* In consideration of typical loss of capacity at storage and application.

Continuous 24h/d

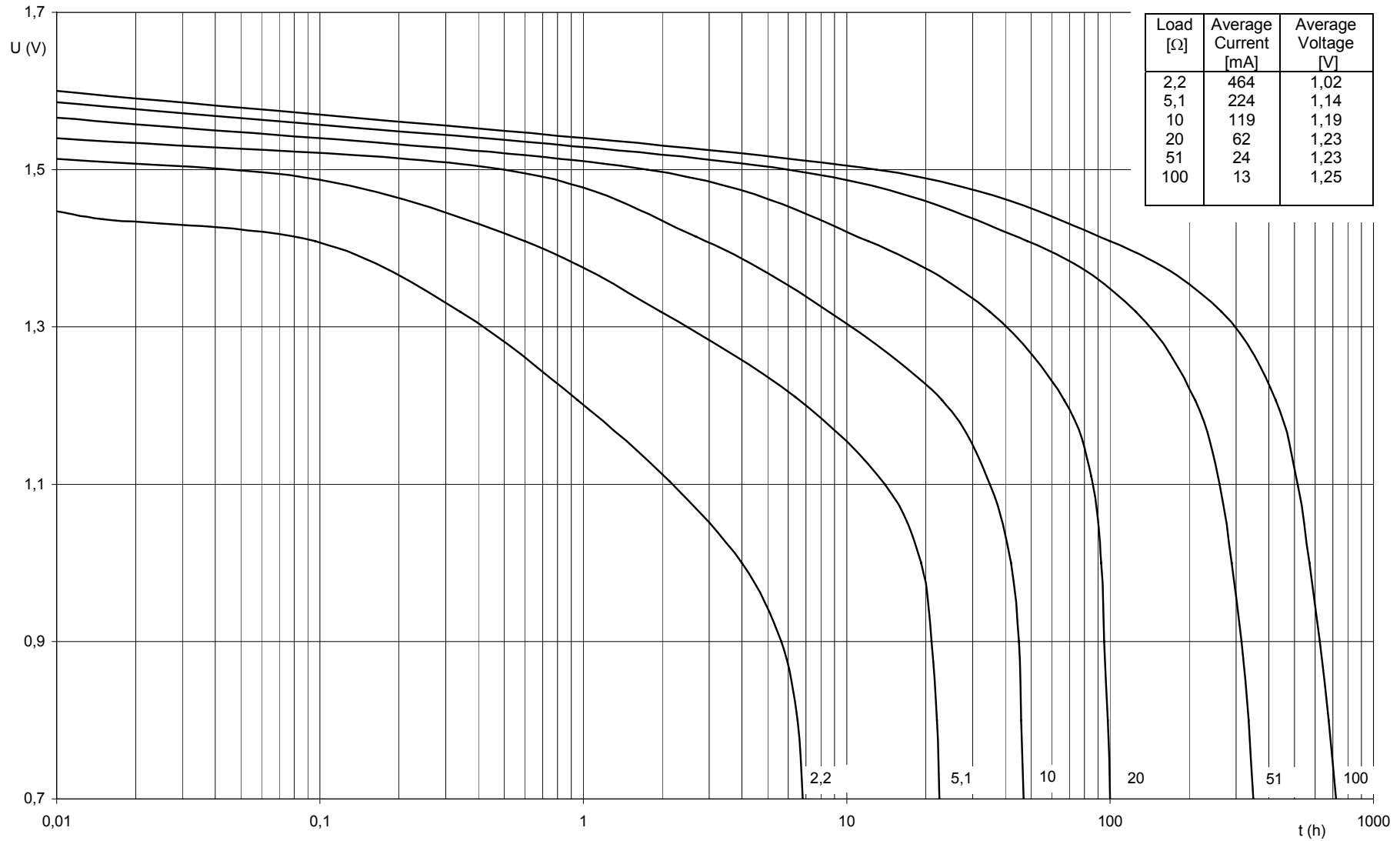

Discontinuous 2h/d

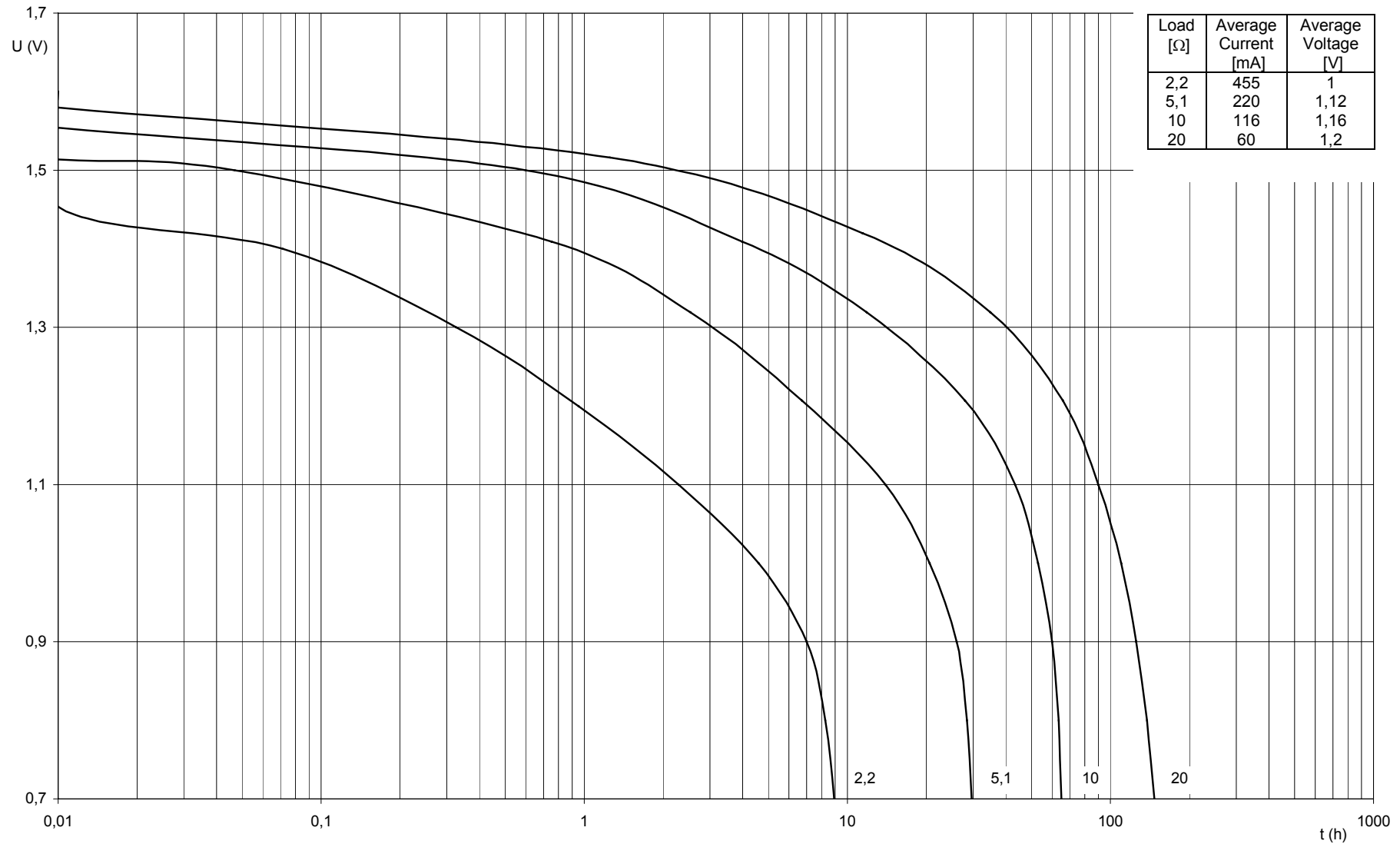

Internal Resistance at Continuous 225 Ω, 1s/1h 2Ω

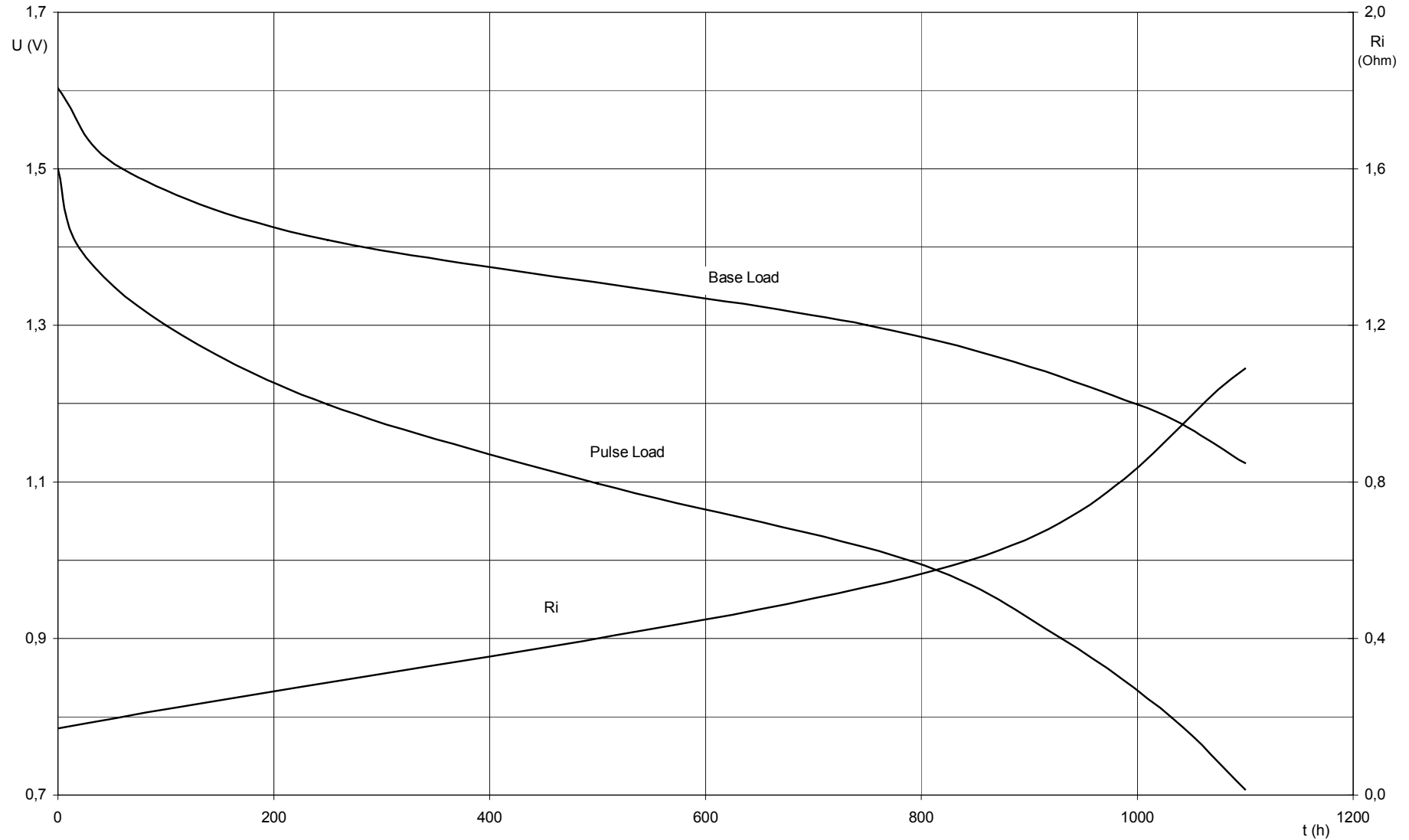

Temperature Characteristic Continuous 10Ω

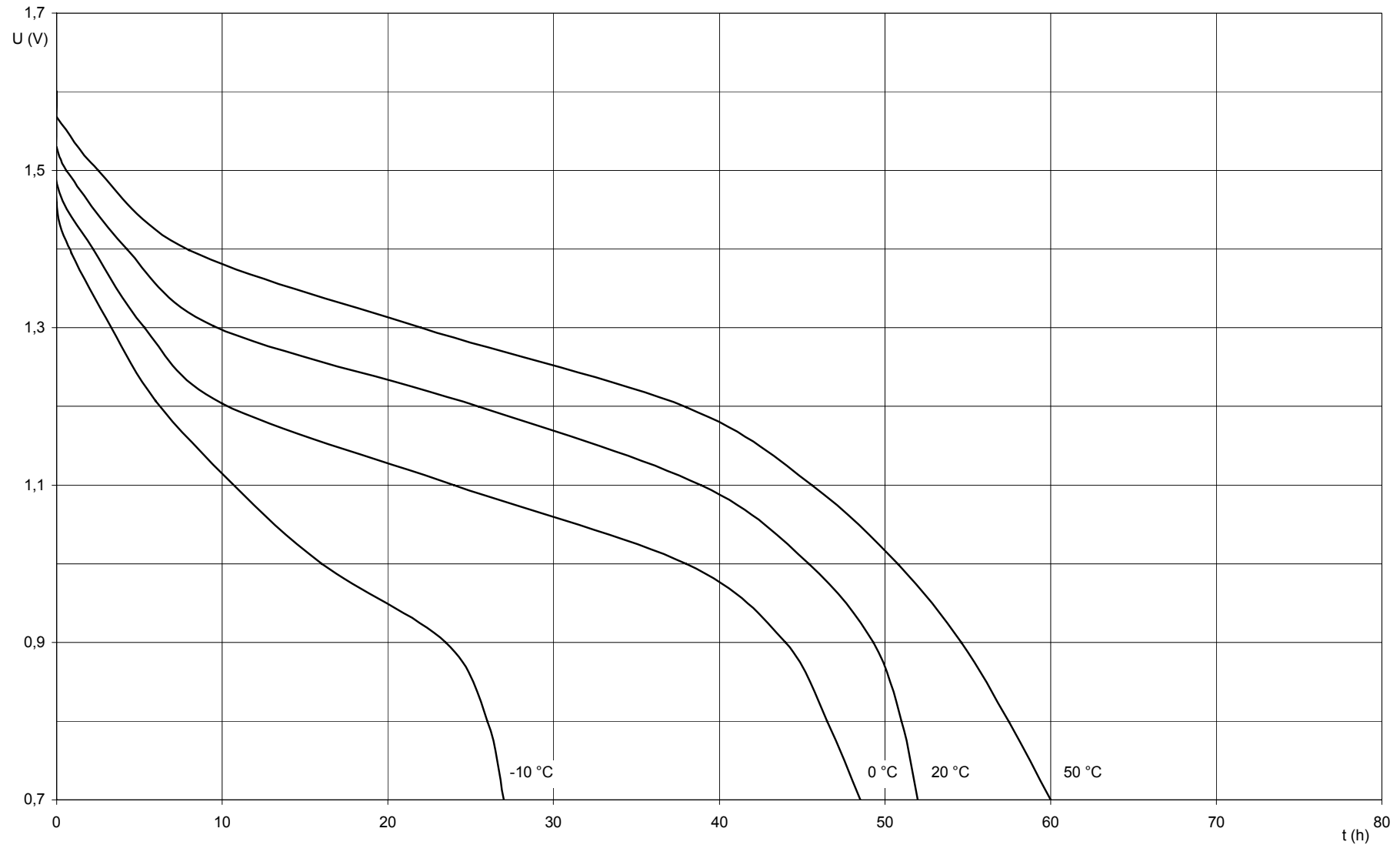

Temperature Characteristic Discontinuous 4h/d 10Ω

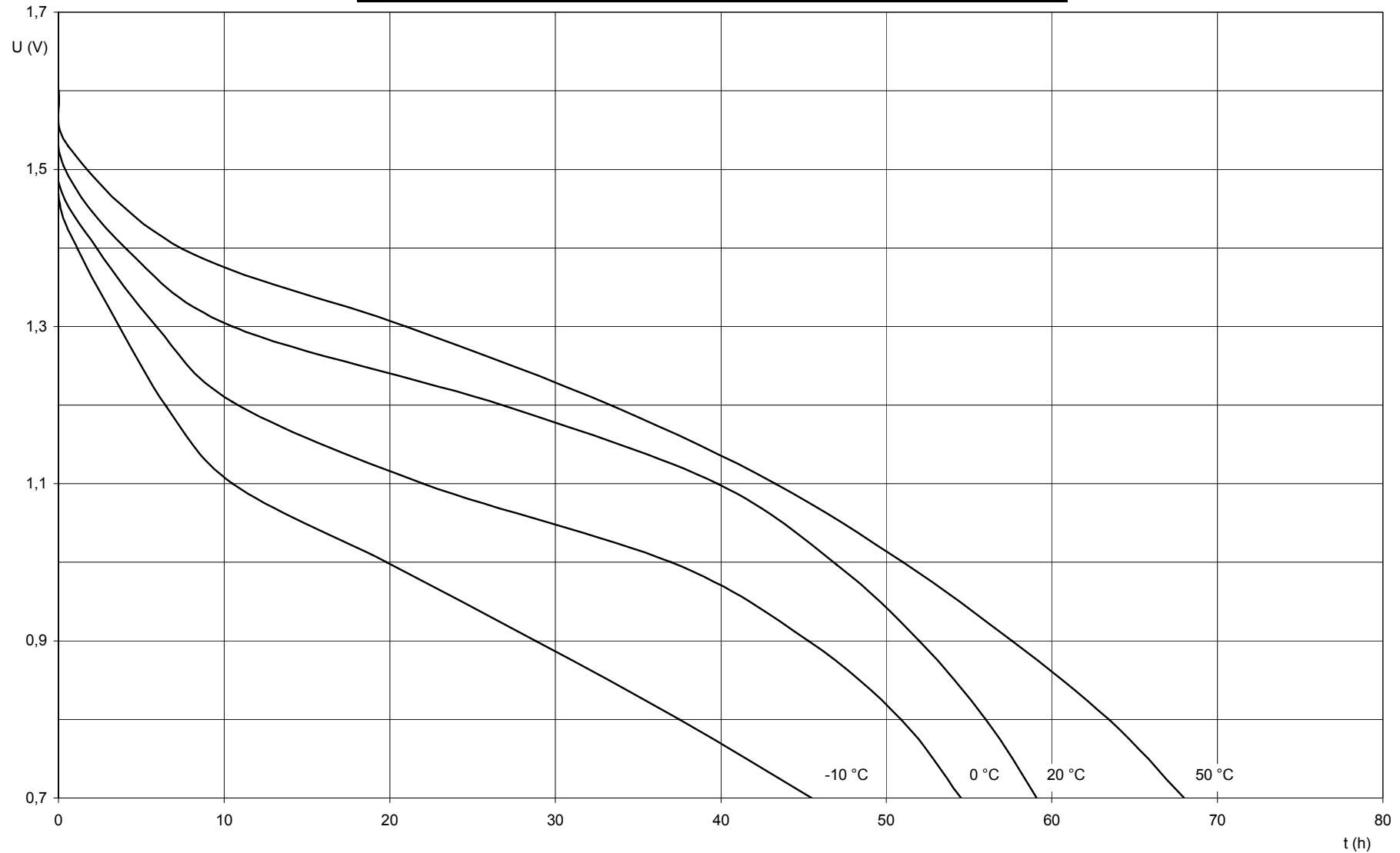

Short Circuit (Current and Temp. versus Time)

